

SMT Power Inductor

SIT612 Type

Features

- RoHS compliant.
- Small size (5.3mm*4.1mm), low profile (1.2mm max. height) SMD type.
- Unshielded.
- High energy storage and low DCR.
- Provided with embossed carrier tape packing.
- Ideal for power source circuits, DC-DC converter, DC-AC inverters inductor application.
- In addition to the standard versions shown here, customized inductors are available to meet your exact requirements.

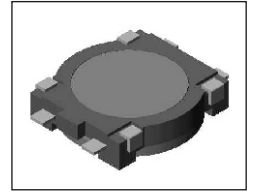

Mechanical Dimension:

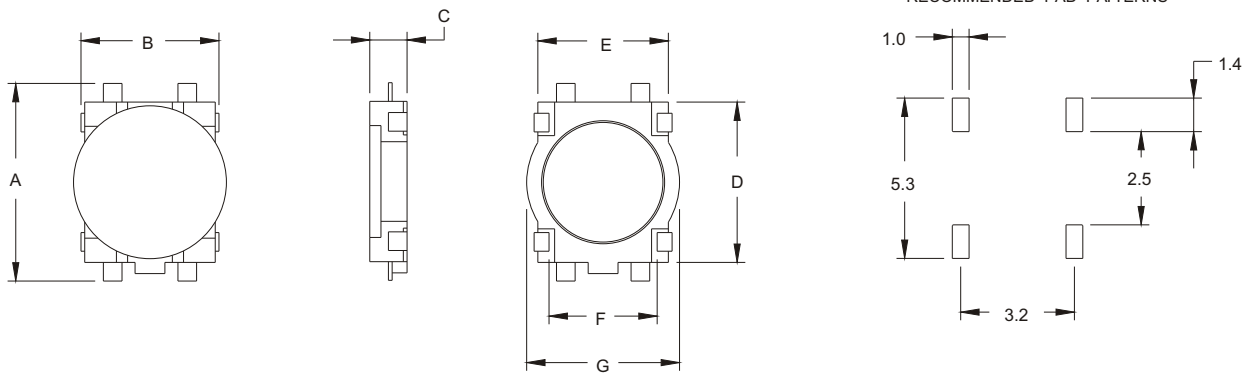

UNIT	A	B	C	D	E	F	G
mm	5.800 Max.	3.700 ± 0.200	1.200 Max.	4.300	3.500	2.900	4.100 ± 0.300
inch	0.228 Max.	0.146 ± 0.008	0.047 Max.	0.169	0.138	0.114	0.161 ± 0.012

Electrical Characteristics: 25°C: 100KHz, 0.1V

PART NO.	L^1 (μ H)	DCR ($m\Omega$) MAX	I_{rated}^2 (A 2)
SIT612 - 2R2	2.2	0.116	0.95
SIT612 - 3R3	3.3	0.174	0.77
SIT612 - 4R7	4.7	0.216	0.75
SIT612 - 6R8	6.8	0.296	0.62
SIT612 - 100	10.0	0.457	0.50
SIT612 - 150	15.0	0.676	0.40
SIT612 - 220	22.0	1.066	0.30
SIT612 - 330	33.0	1.647	0.24
SIT612 - 470	47.0	2.843	0.18

1. Tolerance of inductance: $\pm 20\%$.
2. I_{rated} is the DC current which cause the inductance drop 10% typical of its nominal inductance without current and the surface temperature of the part increase less than 45°C.
3. Operating temperature : -20°C to 105°C (including self-temperature rise).



DELTA ELECTRONICS, INC.

(TAOYUAN PLANT CPBG) 252, SAN YING ROAD, KUEISAN INDUSTRIAL ZONE, TAOYUAN SHIEN, 333, TAIWAN, R.O.C.

TEL: 886-3-3591968; FAX: 886-3-3591991

<http://www.deltawww.com>